

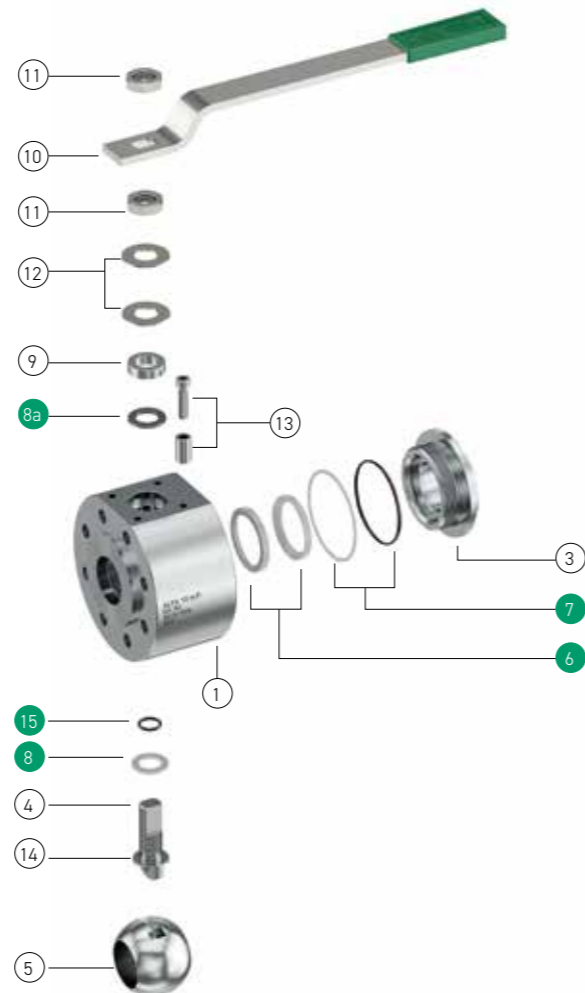

A10HP ANSI 600 wafer type ball valve

PART NAME PARTICOLARE	Q.TY Q.TA'	MATERIALS MATERIALI	
1 body corpo	1	ASTM A105	ASTM A479 316/316L
3 closure chiusura	1	ASTM A105	ASTM A479 316/316L
4 stem stelo	1	ASTM A182 F51	
5 ball sfera	1	ASTM A351 CF8	ASTM A351 CF8M
6 seats sedi	2	TFM / P.T.F.E. + A.M. (DN > 40)	
7 body gasket guarnizione corpo	1	P.T.F.E. / GRAPHOIL (DN > 50)	
8 washer bussola	1	P.T.F.E.	
8a stem gasket guarnizione stelo	1	GRAPHOIL	
9 gland preguarnizione	1	Carbon Steel Zinc Coated	Stainless Steel 316
10 lever leva	1	Carbon Steel Zinc Coated	
11 stem nut dado stelo	2	Cl. 8	A4-40 (AISI 316)
12 spring washer molla a tazza	2	51CrV4 Zinc Coated	AISI 316
13 stop device dispositivo di arresto	1	Cl. 8.8 Zinc Coated	AISI 316
14 antistatic device dispositivo antistatico	2	AISI 316	
15 stem o-ring o-ring stelo	1	VITON 90 Sh. A AED	
16 body o-ring (DN>50) o-ring corpo	1	VITON 90 Sh. A AED	



Spares parts / Parti di ricambio

STANDARD FEATURES CARATTERISTICHE STANDARD

Flange Facing RF according / Finitura Flange secondo : ASME B16.5
Flange drilling, metric holes according / Foratura flange, fori metrici secondo : ASME B16.5, ANSI 600
Face to face / Scartamento : EN 558-1
Design according to / Progettazione secondo : ASME B16.34, EN 12516-1, PED 2014/68/UE
Fire Safe Design and Construction according to / Costruzione e assemblaggio Fire Safe secondo : EN ISO 10497, API 6FA, API 607
Antistatic Device according to / Dispositivo antistatico secondo : BS 5146
Tightness class / Classe di tenuta : VI (FCI 70-2 - ANSI B 16.104)
Stem sealing with O-ring, Anti Blow-out stem / Tenuta stelo con O-Ring, stelo anti-espulsione
Actuator coupling flange according to / Flangia integrata per montaggio comando secondo : ISO 5211

A10HP ANSI 600 CARBON STEEL BODY / CORPO ACCIAIO AL CARBONIO

DN	VALVE RATING	VALVE CODE	DESCRIPTION	VALVE PRICE (€)	KIT CODE	KIT PRICE (€)
15	ANSI 600	A1H15A4C5-0001-M0010	ALFA10HP DN15 ANSI600 A105 FS RF MET		KGA1H15A4-001	
20	ANSI 600	A1H20A4C5-0001-M0010	ALFA10HP DN20 ANSI600 A105 FS RF MET		KGA1H20A4-001	
25	ANSI 600	A1H25A4C5-0001-M0010	ALFA10HP DN25 ANSI600 A105 FS RF MET		KGA1H25A4-001	
32	ANSI 600	A1H32A4C5-0001-M0010	ALFA10HP DN32 ANSI600 A105 FS RF MET		KGA1H32A4-001	
40	ANSI 600	A1H40A4C5-0001-M0010	ALFA10HP DN40 ANSI600 A105 FS RF MET		KGA1H40A4-001	
50	ANSI 600	A1H50A4C5-0001-M0010	ALFA10HP DN50 ANSI600 A105 FS RF MET		KGA1H50A4-001	
65	ANSI 600	A1H65A4C5-0001-M0010	ALFA10HP DN65 ANSI600 A105 FS RF MET		KGA1H65A4-001	
80	ANSI 600	A1H80A4C5-0001-M0010	ALFA10HP DN80 ANSI600 A105 FS RF MET		KGA1H80A4-001	
100	ANSI 600	A1HA0A4C5-0001-K0010	ALFA10HP DN100 ANSI600 A105 FS RF MET BS		KGA1HA0A4-001	(*)

(*) BARE STEM VALVE-VALVOLA A STELO NUDO

A10HP ANSI 600 STAINLESS STEEL BODY / CORPO ACCIAIO INOSSIDABILE

DN	VALVE RATING	VALVE CODE	DESCRIPTION	VALVE PRICE (€)	KIT CODE	KIT PRICE (€)
15	ANSI 600	A1H15A4SD-0001-M0000	ALFA10HP DN15 ANSI600 316/316L FS RF MET		KGA1H15A4-001	
20	ANSI 600	A1H20A4SD-0001-M0000	ALFA10HP DN20 ANSI600 316/316L FS RF MET		KGA1H20A4-001	
25	ANSI 600	A1H25A4SD-0001-M0000	ALFA10HP DN25 ANSI600 316/316L FS RF MET		KGA1H25A4-001	
32	ANSI 600	A1H32A4SD-0001-M0000	ALFA10HP DN32 ANSI600 316/316L FS RF MET		KGA1H32A4-001	
40	ANSI 600	A1H40A4SD-0001-M0000	ALFA10HP DN40 ANSI600 316/316L FS RF MET		KGA1H40A4-001	
50	ANSI 600	A1H50A4SD-0001-M0000	ALFA10HP DN50 ANSI600 316/316L FS RF MET		KGA1H50A4-001	
65	ANSI 600	A1H65A4SD-0001-M0000	ALFA10HP DN65 ANSI600 316/316L FS RF MET		KGA1H65A4-001	
80	ANSI 600	A1H80A4SD-0001-M0000	ALFA10HP DN80 ANSI600 316/316L FS RF MET		KGA1H80A4-001	
100	ANSI 600	A1HA0A4SD-0001-K0000	ALFA10HP DN100 ANSI600 316/316L FS RF MET BS		KGA1HA0A4-001	(*)

(*) BARE STEM VALVE - VALVOLA A STELO NUDO



Product codes in bold are related to product available on stock; delivery time within 3 weeks based on ordered quantity.

All other codes are related to product ready for assembly; delivery time within 5 weeks based on ordered quantity.

Missing Sizes and Special Executions are available upon request. Please contact Sales Dept. for availability and delivery time

I codici in grassetto indicano prodotti normalmente disponibili a stock; consegna entro 3 settimane secondo quantità ordinate

Gli altri codici indicano prodotti disponibili per assemblaggio; consegna entro 5 settimane secondo quantità ordinate

Dimensioni mancanti ed esecuzioni speciali sono disponibili su richiesta. Si prega contattare Ufficio commerciale per disponibilità e consegne