

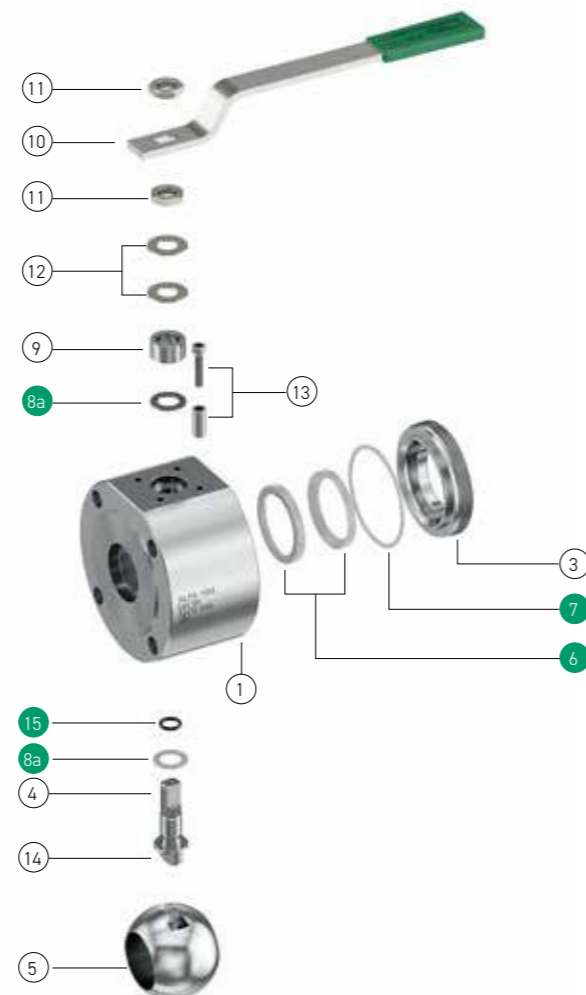

A10N ANSI 150 wafer type ball valve

BAR STOCK BODY
CORPO DA BARRA

PART NAME PARTICOLARE	Q.TY Q.TA'	MATERIALS MATERIALI	
1 body corpo	1	ASTM A105	ASTM A479 316/316L
3 closure chiusura	1	ASTM A105	ASTM A479 316/316L
4 stem stelo	1	ASTM A479 F6a (AISI 410)	ASTM A182 316/316L
5 ball sfera	1	ASTM A351 CF8	ASTM A351 CF8M
6 seats sedi	2		TFM
7 body gasket guarnizione corpo	1		P.T.F.E.
8 washer bussola	1		P.T.F.E.
8a stem gasket guarnizione stelo	1		GRAPHOIL
9 gland premiguarzione	1	Carbon steel Zinc Coated	Stainless Steel 316
10 lever leva	1		Carbon steel Zinc Coated
11 stem nut dado stelo	2	Cl.8	A4-40 (AISI 316)
12 spring washer molla a tazza	2	51 CrV4 Zinc coated	AISI 316
13 stop device dispositivo di arresto	1	Cl. 8.8 Zinc Coated	AISI 316
14 antistatic device dispositivo antistatico	2		AISI 316
15 stem o-ring o-ring stelo	1		VITON 75 Sh. A



Spares parts / Parti di ricambio

STANDARD FEATURES CARATTERISTICHE STANDARD

Flange Facing / Finitura Flange : RF according ASME B16.5, ANSI 150
Flange drilling, metric holes according / Foratura flange, fori metrici secondo : ASME B16.5, ANSI 150
Face to face / Scartamento : EN 558-1
Design according to / Progettazione secondo : ASME B16.34, EN 12516-1, PED 2014/68/UE
Fire Safe Design and Construction according to / Costruzione e assemblaggio Fire Safe secondo : EN ISO 10497, API 6FA, API 607
Antistatic Device according to / Dispositivo antistatico secondo : BS 5146
Tightness class / Classe di tenuta : VI (FCI 70-2 - ANSI B 16.104)
Stem sealing with O-ring, Anti Blow-out stem / Tenuta stelo con O-Ring, stelo anti-espulsione
Actuator coupling flange according to / Flangia integrata per montaggio comando secondo : ISO 5211

A10N ANSI 150 CARBON STEEL BODY / CORPO ACCIAIO AL CARBONIO

DN	VALVE RATING	VALVE CODE	DESCRIPTION	VALVE PRICE (€)	KIT CODE	KIT PRICE (€)
15	ANSI 150	A1N15A1C5-0001-M0010	ALFA10N DN15 ANSI150 A105 FS RF MET		KGA1N15A1-001	
20	ANSI 150	A1N20A1C5-0001-M0010	ALFA10N DN20 ANSI150 A105 FS RF MET		KGA1N20A1-001	
25	ANSI 150	A1N25A1C5-0001-M0010	ALFA10N DN25 ANSI150 A105 FS RF MET		KGA1N25A1-001	
32	ANSI 150	A1N32A1C5-0001-M0010	ALFA10N DN32 ANSI150 A105 FS RF MET		KGA1N32A1-001	
40	ANSI 150	A1N40A1C5-0001-M0010	ALFA10N DN40 ANSI150 A105 FS RF MET		KGA1N40A1-001	
50	ANSI 150	A1N50A1C5-0001-M0010	ALFA10N DN50 ANSI150 A105 FS RF MET		KGA1N50A1-001	
65	ANSI 150	A1N65A1C5-0001-M0010	ALFA10N DN65 ANSI150 A105 FS RF MET		KGA1N65A1-001	
80	ANSI 150	A1N80A1C5-0001-M0010	ALFA10N DN80 ANSI150 A105 FS RF MET		KGA1N80A1-001	
100	ANSI 150	A1NA0A1C5-0001-M0010	ALFA10N DN100 ANSI150 A105 FS RF MET		KGA1NA0A1-001	

A10N ANSI 150 STAINLESS STEEL BODY / CORPO ACCIAIO INOSSIDABILE

DN	VALVE RATING	VALVE CODE	DESCRIPTION	VALVE PRICE (€)	KIT CODE	KIT PRICE (€)
15	ANSI 150	A1N15A1SD-0001-M0000	ALFA10N DN15 ANSI150 316/316L FS RF MET		KGA1N15A1-001	
20	ANSI 150	A1N20A1SD-0001-M0000	ALFA10N DN20 ANSI150 316/316L FS RF MET		KGA1N20A1-001	
25	ANSI 150	A1N25A1SD-0001-M0000	ALFA10N DN25 ANSI150 316/316L FS RF MET		KGA1N25A1-001	
32	ANSI 150	A1N32A1SD-0001-M0000	ALFA10N DN32 ANSI150 316/316L FS RF MET		KGA1N32A1-001	
40	ANSI 150	A1N40A1SD-0001-M0000	ALFA10N DN40 ANSI150 316/316L FS RF MET		KGA1N40A1-001	
50	ANSI 150	A1N50A1SD-0001-M0000	ALFA10N DN50 ANSI150 316/316L FS RF MET		KGA1N50A1-001	
65	ANSI 150	A1N65A1SD-0001-M0000	ALFA10N DN65 ANSI150 316/316L FS RF MET		KGA1N65A1-001	
80	ANSI 150	A1N80A1SD-0001-M0000	ALFA10N DN80 ANSI150 316/316L FS RF MET		KGA1N80A1-001	
100	ANSI 150	A1NA0A1SD-0001-M0000	ALFA10N DN100 ANSI150 316/316L FS RF MET		KGA1NA0A1-001	



Product codes in bold are related to product available on stock; delivery time within 3 weeks based on ordered quantity.

All other codes are related to product ready for assembly; delivery time within 5 weeks based on ordered quantity.

Missing Sizes and Special Executions are available upon request. Please contact Sales Dept. for availability and delivery time

I codici in grassetto indicano prodotti normalmente disponibili a stock; consegna entro 3 settimane secondo quantità ordinate

Gli altri codici indicano prodotti disponibili per assemblaggio; consegna entro 5 settimane secondo quantità ordinate

Dimensioni mancanti ed esecuzioni speciali sono disponibili su richiesta. Si prega contattare Ufficio commerciale per disponibilità e consegne