

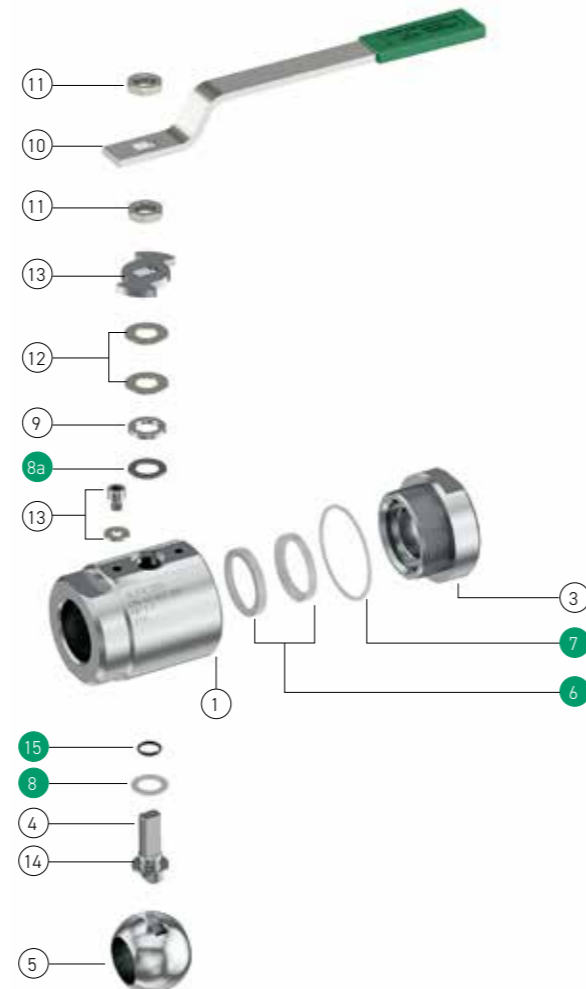

## A20R 800lb screwed body type ball valve - reduced bore

PART NAME PARTICOLARE	Q.TY Q.TA'	MATERIALS MATERIALI	
1 body corpo	1	ASTM A105N/LF2	ASTM A479 316/316L
3 closure chiusura	1	ASTM A105N/LF2	ASTM A479 316/316L
4 stem stelo	1	ASTMA182 F51	ASTM A182 F51
5 ball sfera	1	ASTM A351 CF8	ASTM A351 CF8M
6 seats sedi	2		TFM
7 body gasket guarnizione corpo	1		P.T.F.E.
8 washer bussola	1		P.T.F.E.
8a stem gasket guarnizione stelo	1		GRAPHOIL
9 gland premi-guarnizione	1	Carbon steel Zinc Coated	Stainless Steel 316
10 lever leva	1		Carbon steel Zinc Coated
11 stem nut dado stelo	2	CL8	A4-40 (AISI 316)
12 spring washer molla a tazza	2	51 CrV4 Zinc coated	AISI 316
13 stop device dispositivo di arresto	1	CL. 8.8 Zinc Coated	AISI 316
14 antistatic device dispositivo antistatico	1		AISI 316
15 stem o-ring o-ring stelo	1		VITON 75 Sh. A



Spares parts / Parti di ricambio

### STANDARD FEATURES CARATTERISTICHE STANDARD

Flange Facing / Finitura Flange : NPT (ASME B1.20.1)-GAS (ISO 228/1)-BW Sch.80 (ASME B16.25)  
SW (ASME B16.11)

Face to face / Scartamento : Manufacturer standard

Design according to / Progettazione secondo : ASME B16.34, EN 12516-1, EN 17292, PED 2014/68/UE

Fire Safe Design and Construction according to / Costruzione e assemblaggio Fire Safe secondo :  
EN ISO 10497, API 6FA, API 607

Antistatic Device according to / Dispositivo antistatico secondo : BS 5146

Tightness class / Classe di tenuta : VI (FCI 70-2 - ANSI B 16.104)

Stem sealing with O-ring, Anti Blow-out stem / Tenuta stelo con O-Ring, stelo anti-espulsione

### A20R 800lb CARBON STEEL BODY / CORPO ACCIAIO AL CARBONIO

A105N  
(LF2)

DN	VALVE RATING	VALVE CODE	DESCRIPTION	VALVE PRICE (€)	KIT CODE	KIT PRICE (€)
15	800lb	<b>A2R15P3CN-0001-M0090</b>	<b>ALFA20R DN15 800lb A105N GAS FS</b>		<b>N.A. (*)</b>	
15	800lb	<b>A2R15P3CN-0002-M0090</b>	<b>ALFA20R DN15 800lb A105N NPT FS</b>		<b>N.A. (*)</b>	
15	800lb	A2R15P3CN-0002-M0010	ALFA20R DN15 800lb A105N BW FS		N.A. (*)	
15	800lb	A2R15P3CN-0001-M0010	ALFA20R DN15 800lb A105N SW FS		N.A. (*)	
20	800lb	<b>A2R20P3CN-0002-M0090</b>	<b>ALFA20R DN20 800lb A105N GAS FS</b>		<b>KGA2T15P3-001</b>	
20	800lb	<b>A2R20P3CN-0001-M0090</b>	<b>ALFA20R DN20 800lb A105N NPT FS</b>		<b>KGA2T15P3-001</b>	
20	800lb	A2R20P3CN-0002-M0010	ALFA20R DN20 800lb A105N BW FS		KGA2T15P3-001	
20	800lb	A2R20P3CN-0001-M0010	ALFA20R DN20 800lb A105N SW FS		KGA2T15P3-001	
25	800lb	<b>A2R25P3CN-0002-M0090</b>	<b>ALFA20R DN25 800lb A105N GAS FS</b>		<b>KGA2T20P3-001</b>	
25	800lb	<b>A2R25P3CN-0001-M0090</b>	<b>ALFA20R DN25 800lb A105N NPT FS</b>		<b>KGA2T20P3-001</b>	

(\*) FOR VALVES DN15 SPARE PARTS KIT WILL NOT BE AVAILABLE - I KIT DI RICAMBIO NON SONO DISPONIBILI PER VALVOLE DN15

### A20R 800lb STAINLESS STEEL BODY / CORPO ACCIAIO INOSSIDABILE

316(L)

DN	VALVE RATING	VALVE CODE	DESCRIPTION	VALVE PRICE (€)	KIT CODE	KIT PRICE (€)
15	800lb	<b>A2R15P3SD-0002-M0000</b>	<b>ALFA20R DN15 800lb 316/316L GAS FS</b>		<b>N.A. (*)</b>	
15	800lb	<b>A2R15P3SD-0003-M0000</b>	<b>ALFA20R DN15 800lb 316/316L NPT FS</b>		<b>N.A. (*)</b>	
20	800lb	<b>A2R20P3SD-0002-M0000</b>	<b>ALFA20R DN20 800lb 316/316L GAS FS</b>		<b>KGA2T15P3-001</b>	
20	800lb	<b>A2R20P3SD-0001-M0000</b>	<b>ALFA20R DN20 800lb 316/316L NPT FS</b>		<b>KGA2T15P3-001</b>	
25	800lb	<b>A2R25P3SD-0002-M0000</b>	<b>ALFA20R DN25 800lb 316/316L GAS FS</b>		<b>KGA2T20P3-001</b>	
25	800lb	<b>A2R25P3SD-0001-M0000</b>	<b>ALFA20R DN25 800lb 316/316L NPT FS</b>		<b>KGA2T20P3-001</b>	

(\*) FOR VALVES DN15 SPARE PARTS KIT WILL NOT BE AVAILABLE - I KIT DI RICAMBIO NON SONO DISPONIBILI PER VALVOLE DN15



**Product codes in bold are related to product available on stock; delivery time within 3 weeks based on ordered quantity.**

All other codes are related to product ready for assembly; delivery time within 5 weeks based on ordered quantity.

Missing Sizes and Special Executions are available upon request. Please contact Sales Dept. for availability and delivery time

**I codici in grassetto indicano prodotti normalmente disponibili a stock; consegna entro 3 settimane secondo quantità ordinate**

Gli altri codici indicano prodotti disponibili per assemblaggio; consegna entro 5 settimane secondo quantità ordinate

Dimensioni mancanti ed esecuzioni speciali sono disponibili su richiesta. Si prega contattare Ufficio commerciale per disponibilità e consegne