

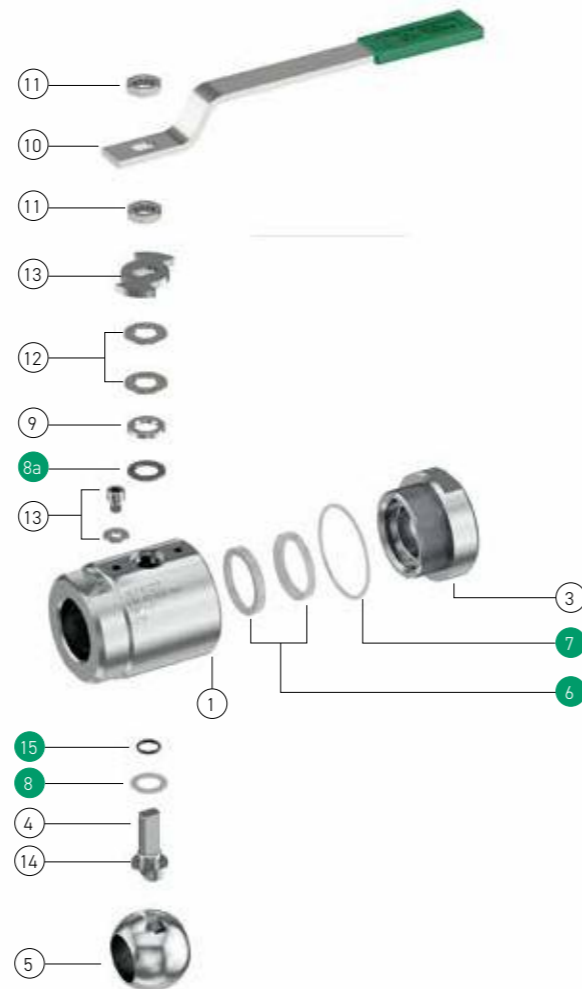

## A20T 800lb screwed body type ball valve - full bore

| PART NAME<br>PARTICOLARE                        | Q.TY<br>Q.TA' | MATERIALS<br>MATERIALI   |                     |
|---|---------------|--------------------------|---------------------|
| 1 body<br>corpo                                 | 1             | ASTM A105N/LF2           | ASTM A479 316/316L  |
| 3 closure<br>chiusura                           | 1             | ASTM A105N/LF2           | ASTM A479 316/316L  |
| 4 stem<br>stelo                                 | 1             | ASTM A182 F51            |                     |
| 5 ball<br>sfera                                 | 1             | ASTM A351 CF8            | ASTM A351 CF8M      |
| 6 seats<br>sedi                                 | 2             | TFM                      |                     |
| 7 body gasket<br>guarnizione corpo              | 1             | P.T.F.E.                 |                     |
| 8 washer<br>bussola                             | 1             | P.T.F.E.                 |                     |
| 8a stem gasket<br>guarnizione stelo             | 1             | GRAPHOIL                 |                     |
| 9 gland<br>premi-guarnizione                    | 1             | Carbon steel Zinc Coated | Stainless Steel 316 |
| 10 lever<br>leva                                | 1             | Carbon steel Zinc Coated |                     |
| 11 stem nut<br>dado stelo                       | 2             | CL8                      | A4-40 (AISI 316)    |
| 12 spring washer<br>molla a tazza               | 2             | 51 CrV4 Zinc coated      | AISI 316            |
| 13 stop device<br>dispositivo di arresto        | 1             | Cl. 8.8 Zinc Coated      | AISI 316            |
| 14 antistatic device<br>dispositivo antistatico | 1             | AISI 316                 |                     |
| 15 stem o-ring<br>o-ring stelo                  | 1             | VITON 75 Sh. A           |                     |



Spares parts / Parti di ricambio

### STANDARD FEATURES CARATTERISTICHE STANDARD

Flange Facing / Finitura Flange : NPT (ASME B1.20.1)-GAS (ISO 228/1)-BW Sch.80 (ASME B16.25)  
SW (ASME B16.11)

Face to face / Scartamento : Manufacturer standard

Design according to / Progettazione secondo : ASME B16.34, EN 12516-1, EN 17292, PED 2014/68/UE

Fire Safe Design and Construction according to / Costruzione e assemblaggio Fire Safe secondo :  
EN ISO 10497, API 6FA, API 607

Antistatic Device according to / Dispositivo antistatico secondo : BS 5146

Tightness class / Classe di tenuta : VI (FCI 70-2 - ANSI B 16.104)

Stem sealing with O-ring, Anti Blow-out stem / Tenuta stelo con O-Ring, stelo anti-espulsione

### A20T 800lb CARBON STEEL BODY / CORPO ACCIAIO AL CARBONIO

| DN        | VALVE RATING | VALVE CODE                  | DESCRIPTION                            | VALVE PRICE (€) | KIT CODE             | KIT PRICE (€) |
|-----------|--------------|-----------------------------|--|-----------------|----------------------|---------------|
| 06        | 800lb        | A2T06P3CN-0002-M0090        | ALFA20T DN06 800lb A105N GAS FS        |                 | N.A. (*)             |               |
| 06        | 800lb        | A2T06P3CN-0001-M0090        | ALFA20T DN06 800lb A105N NPT FS        |                 | N.A. (*)             |               |
| 10        | 800lb        | A2T10P3CN-0002-M0090        | ALFA20T DN10 800lb A105N GAS FS        |                 | N.A. (*)             |               |
| 10        | 800lb        | A2T10P3CN-0001-M0090        | ALFA20T DN10 800lb A105N NPT FS        |                 | N.A. (*)             |               |
| <b>15</b> | <b>800lb</b> | <b>A2T15P3CN-0002-M0090</b> | <b>ALFA20T DN15 800lb A105N GAS FS</b> |                 | <b>KGA2T15P3-001</b> |               |
| <b>15</b> | <b>800lb</b> | <b>A2T15P3CN-0001-M0090</b> | <b>ALFA20T DN15 800lb A105N NPT FS</b> |                 | <b>KGA2T15P3-001</b> |               |
| 15        | 800lb        | A2T15P3CN-0002-M0010        | ALFA20T DN15 800lb A105N BW FS         |                 | KGA2T15P3-001        |               |
| 15        | 800lb        | A2T15P3CN-0001-M0010        | ALFA20T DN15 800lb A105N SW FS         |                 | KGA2T15P3-001        |               |
| <b>20</b> | <b>800lb</b> | <b>A2T20P3CN-0002-M0090</b> | <b>ALFA20T DN20 800lb A105N GAS FS</b> |                 | <b>KGA2T20P3-001</b> |               |
| <b>20</b> | <b>800lb</b> | <b>A2T20P3CN-0001-M0090</b> | <b>ALFA20T DN20 800lb A105N NPT FS</b> |                 | <b>KGA2T20P3-001</b> |               |
| 20        | 800lb        | A2T20P3CN-0002-M0010        | ALFA20T DN20 800lb A105N BW FS         |                 | KGA2T20P3-001        |               |
| 20        | 800lb        | A2T20P3CN-0001-M0010        | ALFA20T DN20 800lb A105N SW FS         |                 | KGA2T20P3-001        |               |
| <b>25</b> | <b>800lb</b> | <b>A2T25P3CN-0002-M0090</b> | <b>ALFA20T DN25 800lb A105N GAS FS</b> |                 | <b>KGA2T25P3-001</b> |               |
| <b>25</b> | <b>800lb</b> | <b>A2T25P3CN-0001-M0090</b> | <b>ALFA20T DN25 800lb A105N NPT FS</b> |                 | <b>KGA2T25P3-001</b> |               |
| 25        | 800lb        | A2T25P3CN-0002-M0010        | ALFA20T DN25 800lb A105N BW FS         |                 | KGA2T25P3-001        |               |
| 25        | 800lb        | A2T25P3CN-0001-M0010        | ALFA20T DN25 800lb A105N SW FS         |                 | KGA2T25P3-001        |               |
| 32        | 800lb        | A2T32P3CN-0002-M0090        | ALFA20T DN32 800lb A105N GAS FS        |                 | KGA2T32P3-001        |               |
| 32        | 800lb        | A2T32P3CN-0001-M0090        | ALFA20T DN32 800lb A105N NPT FS        |                 | KGA2T32P3-001        |               |
| <b>40</b> | <b>800lb</b> | <b>A2T40P3CN-0002-M0090</b> | <b>ALFA20T DN40 800lb A105N GAS FS</b> |                 | <b>KGA2T40P3-001</b> |               |
| <b>40</b> | <b>800lb</b> | <b>A2T40P3CN-0001-M0090</b> | <b>ALFA20T DN40 800lb A105N NPT FS</b> |                 | <b>KGA2T40P3-001</b> |               |
| 40        | 800lb        | A2T40P3CN-0002-M0010        | ALFA20T DN40 800lb A105N BW FS         |                 | KGA2T40P3-001        |               |
| 40        | 800lb        | A2T40P3CN-0001-M0010        | ALFA20T DN40 800lb A105N SW FS         |                 | KGA2T40P3-001        |               |
| 50        | 800lb        | A2T50P3CN-0002-M0090        | ALFA20T DN50 800lb A105N GAS FS        |                 | KGA2T50P3-001        |               |
| 50        | 800lb        | A2T50P3CN-0001-M0090        | ALFA20T DN50 800lb A105N NPT FS        |                 | KGA2T50P3-001        |               |

(\*) FOR VALVES DN06/DN10 SPARE PARTS KIT WILL NOT BE AVAILABLE - I KIT DI RICAMBIO NON SONO DISPONIBILI PER VALVOLE DN06/10

### A20T 800lb STAINLESS STEEL BODY / CORPO ACCIAIO INOSSIDABILE

| DN        | VALVE RATING | VALVE CODE                  | DESCRIPTION                               | VALVE PRICE (€) | KIT CODE             | KIT PRICE (€) |
|-----------|--------------|-----------------------------|---|-----------------|----------------------|---------------|
| <b>06</b> | <b>800lb</b> | <b>A2T06P3SD-0002-M0000</b> | <b>ALFA20T DN06 800lb 316/316L GAS FS</b> |                 | <b>N.A. (*)</b>      |               |
| <b>06</b> | <b>800lb</b> | <b>A2T06P3SD-0001-M0000</b> | <b>ALFA20T DN06 800lb 316/316L NPT FS</b> |                 | <b>N.A. (*)</b>      |               |
| 10        | 800lb        | A2T10P3SD-0002-M0000        | ALFA20T DN10 800lb 316/316L GAS FS        |                 | N.A. (*)             |               |
| 10        | 800lb        | A2T10P3SD-0001-M0000        | ALFA20T DN10 800lb 316/316L NPT FS        |                 | N.A. (*)             |               |
| <b>15</b> | <b>800lb</b> | <b>A2T15P3SD-0002-M0000</b> | <b>ALFA20T DN15 800lb 316/316L GAS FS</b> |                 | <b>KGA2T15P3-001</b> |               |
| <b>15</b> | <b>800lb</b> | <b>A2T15P3SD-0001-M0000</b> | <b>ALFA20T DN15 800lb 316/316L NPT FS</b> |                 | <b>KGA2T15P3-001</b> |               |
| 15        | 800lb        | A2T15P3SD-0004-M0000        | ALFA20T DN15 800lb 316/316L BW FS         |                 | KGA2T15P3-001        |               |
| 15        | 800lb        | A2T15P3SD-0003-M0000        | ALFA20T DN15 800lb 316/316L SW FS         |                 | KGA2T15P3-001        |               |
| <b>20</b> | <b>800lb</b> | <b>A2T20P3SD-0003-M0000</b> | <b>ALFA20T DN20 800lb 316/316L GAS FS</b> |                 | <b>KGA2T20P3-001</b> |               |
| <b>20</b> | <b>800lb</b> | <b>A2T20P3SD-0004-M0000</b> | <b>ALFA20T DN20 800lb 316/316L NPT FS</b> |                 | <b>KGA2T20P3-001</b> |               |
| 20        | 800lb        | A2T20P3SD-0006-M0000        | ALFA20T DN20 800lb 316/316L BW FS         |                 | KGA2T20P3-001        |               |
| 20        | 800lb        | A2T20P3SD-0005-M0000        | ALFA20T DN20 800lb 316/316L SW FS         |                 | KGA2T20P3-001        |               |
| <b>25</b> | <b>800lb</b> | <b>A2T25P3SD-0003-M0000</b> | <b>ALFA20T DN25 800lb 316/316L GAS FS</b> |                 | <b>KGA2T25P3-001</b> |               |
| <b>25</b> | <b>800lb</b> | <b>A2T25P3SD-0001-M0000</b> | <b>ALFA20T DN25 800lb 316/316L NPT FS</b> |                 | <b>KGA2T25P3-001</b> |               |
| 25        | 800lb        | A2T25P3SD-0005-M0000        | ALFA20T DN25 800lb 316/316L BW FS         |                 | KGA2T25P3-001        |               |
| 25        | 800lb        | A2T25P3SD-0004-M0000        | ALFA20T DN25 800lb 316/316L SW FS         |                 | KGA2T25P3-001        |               |
| <b>40</b> | <b>800lb</b> | <b>A2T40P3SD-0002-M0000</b> | <b>ALFA20T DN40 800lb 316/316L GAS FS</b> |                 | <b>KGA2T40P3-001</b> |               |
| <b>40</b> | <b>800lb</b> | <b>A2T40P3SD-0001-M0000</b> | <b>ALFA20T DN40 800lb 316/316L NPT FS</b> |                 | <b>KGA2T40P3-001</b> |               |
| 40        | 800lb        | A2T40P3SD-0004-M0000        | ALFA20T DN40 800lb 316/316L BW FS         |                 | KGA2T40P3-001        |               |
| 40        | 800lb        | A2T40P3SD-0003-M0000        | ALFA20T DN40 800lb 316/316L SW FS         |                 | KGA2T40P3-001        |               |
| 50        | 800lb        | A2T50P3SD-0002-M0000        | ALFA20T DN50 800lb 316/316L GAS FS        |                 | KGA2T50P3-001        |               |
| 50        | 800lb        | A2T50P3SD-0001-M0000        | ALFA20T DN50 800lb 316/316L NPT FS        |                 | KGA2T50P3-001        |               |
| 50        | 800lb        | A2T50P3SD-0004-M0000        | ALFA20T DN50 800lb 316/316L BW FS         |                 | KGA2T50P3-001        |               |
| 50        | 800lb        | A2T50P3SD-0003-M0000        | ALFA20T DN50 800lb 316/316L SW FS         |                 | KGA2T50P3-001        |               |

(\*) FOR VALVES DN06/DN10 SPARE PARTS KIT WILL NOT BE AVAILABLE - I KIT DI RICAMBIO NON SONO DISPONIBILI PER VALVOLE DN06/10



Product codes in bold are related to product available on stock; delivery time within 3 weeks based on ordered quantity.

All other codes are related to product ready for assembly; delivery time within 5 weeks based on ordered quantity.

Missing Sizes and Special Executions are available upon request. Please contact Sales Dept. for availability and delivery time

I codici in grassetto indicano prodotti normalmente disponibili a stock; consegna entro 3 settimane secondo quantità ordinate

Gli altri codici indicano prodotti disponibili per assemblaggio; consegna entro 5 settimane secondo quantità ordinate

Dimensioni mancanti ed esecuzioni speciali sono disponibili su richiesta. Si prega contattare Ufficio commerciale per disponibilità e consegne